



## Exhibition and Corporate Support

IEEE Visualization 2002 is the premier forum for innovations in visualization methods in science, engineering, commerce, and entertainment. This event brings together visualization researchers and practitioners with an interest in techniques, tools, and technology. The conference will include workshops, tutorials, papers, panels, case studies, posters, demos, and exhibitions.

The Information Visualization Symposium ([InfoVis 2002](#)) will be held on Monday and Tuesday. The focus is on bio-informatics visualization, visualization of commerce and financial systems, graph / network visualization, multi-dimensional information visualization, and visual data mining and knowledge discovery. Volume Visualization and Graphics Symposium ([VolVis 2002](#)) will also be held on Monday and Tuesday. Of special interest are bio-medical visualization, visualization of large volumetric datasets, and volume graphics modeling and rendering.

Applications for exhibiting at or supporting Vis2002 should be sent via e-mail to Matt Ward at [matt@cs.wpi.edu](mailto:matt@cs.wpi.edu) no later than **September 20, 2002**. Please include the name of your company and a one-page description of the visualization product or products your company develops or markets. If you wish to exhibit, please also include the names and contact information of the company personnel who will be responsible for the exhibit, as well as your space and power requirements (see the forms that follow).

### Why Support & Exhibit at Vis2002?

- Boston has thriving local bio-tech, bio-informatics, and information technology communities, including a large number of clinical staff.
- Over 600 developers and users of visualization technology across all areas of science, engineering, medicine, and commerce attend this conference.
- Visualization 2002 is putting a renewed emphasis on the vendor exhibition, which will start Tuesday and be co-located with the reception on Wednesday.
- Visualization 2002 provides an opportunity to recruit outstanding people that are knowledgeable in the latest visualization technologies.
- The conference provides a once-a-year opportunity to meet potential customers from companies around the world.
- Exhibitors and supporters will be allowed to place direct links to their company's home page from the conference web page.
- Company names and logos for exhibitors and supporters will be published in the Advanced and Final Program.
- Visualization 2002 offers attendees an Exhibits-Only registration option, enabling potential customers to see your products without having to register for the full conference.
- Exhibitors will enjoy exclusive access to attendees in a relaxed, informal atmosphere.

### Categories of Sponsoring/Exhibiting

Companies and organizations may choose from among these categories of participation in the Visualization 2002 Conference.

- **Supporter Gold, \$5000**

- Two complimentary registrations for Sunday/Monday/Tuesday or conference (Wednesday-Friday) (includes proceedings, DVD, and Monday or Wednesday reception ticket).
  - Signage recognizing supporter and option to display a banner with corporate logo at the receptions.
  - Optional exhibition space size of 2 units.
  - Recognition in printed materials under "Supporter Gold" and optionally under "Exhibitor".
- **Supporter, \$2500**
    - One complimentary registration for Sunday/Monday/Tuesday or conference (Wednesday-Friday) (includes proceedings, DVD, and Monday or Wednesday reception ticket).
    - Signage recognizing supporter.
    - Optional exhibition space size of 1 unit.
    - Recognition in printed materials under "Supporter" and optionally under "Exhibitor".
- **Non-Profit Supporter, \$500**
    - Only non-profit organizations are eligible.
    - Exhibitor registration (includes Wednesday reception ticket).
    - Optional exhibition space size of 1 unit.
    - Recognition in printed materials listed under "Supporter" and optionally under "Exhibitor".
- **Publisher, \$500**
    - Exhibitor registration (includes Wednesday reception ticket).
    - Exhibition space size of 1 unit.
    - Recognition in printed materials listed under "Exhibitor".
- **Academic Institution Exhibitor, No Fee**
    - Exhibition space size of 1 unit (in the exhibit area or the Interactive Demonstrations Lab).
    - Recognition in printed materials listed under "Exhibitor".

## Deadlines

9/20/02 Requests due for exhibiting / supporting

10/21/02 Deadline for Corporate Vendor Suite selection

For more information regarding supporting and/or exhibiting at Visualization 2002 please contact:

Matt Ward  
 Computer Science Department  
 WPI  
 100 Institute Rd.  
 Worcester, MA 01609  
 (508) 831-5671 (voice)  
 (508) 831-5776 (fax)  
[matt@cs.wpi.edu](mailto:matt@cs.wpi.edu) (e-mail).



## Installation and Dismantling Procedures for Exhibitors

### General

The exhibition will be held in the **Stanbro Room** of the Boston Park Plaza Hotel. (Please see the floor plan below.) By the time you arrive, your booth location will be marked. To streamline the attendee flow in the exhibition hall, demonstration chairs will allocate booth locations.

Mezzanine  
Floor

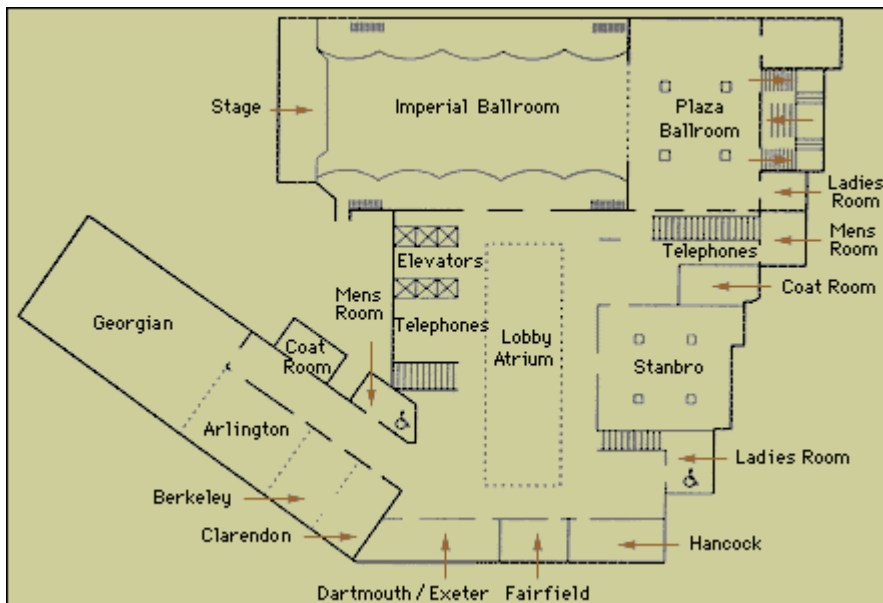

Please ship your items to the following address:

**Boston Park Plaza Hotel**  
**64 Arlington Street**  
**Boston, MA 02116**  
**Attn: Rebecca Peck +1 617 457 2439**  
**IEEE Visualization 2002, 27 Oct – 1 Nov**  
**Receiver: Matthew Ward**

If your items are shipped early in advance, all the material will be at your booth location by the time you arrive for installation. Items should not arrive before 24 October 2002.

Vis 2002 conference will provide 24-hour security for the demonstration room.

As stated in the Call for Demonstration, Corporate Partners will be get two 8-ft. tables, and other exhibitors will get one 8-ft. table. Power for all the booths will be provided free of charge by the conference. Please specify special power requirements on the attached form. You can bring your own display backdrop but not a full size booth due to space limitations. If requested, corkboards for hanging poster(s) (one or two depending on number of tables) will be provided by the conference. Other materials for hanging posters and displays must be provided by the Exhibitors.

In addition, Supporter Gold will receive two complimentary registrations for the conference, and Supporters will receive one complimentary registration for the conference. Each complimentary registration includes conference admission and a single copy of the conference proceedings. Please fill the attached form for early registration. The deadline for early registration is 4 October 2002. Please make every effort to meet the registration deadline with your list. Ten free “Demonstration Only” badges will be furnished upon request at the Registration Desk.

As done in the past, IEEE will provide insurance coverage all the hardware brought in by exhibitors. Please take advantage of this free coverage by filling out the attached form with detailed information about your specific hardware. These forms must be provided by 11 October 2002.

All the exhibitors will be able to attend the Conference Reception on Wednesday night. As done in the previous years, the Exhibition Hall will be open during the Conference Reception.

Security personnel will ask every person removing material from the exhibit hall to show a “Property Removal Pass”. Blank Property Removal Passes can be obtained from the Registration Desk.

## **Installation**

Vis 2002 Exhibitors may begin installation on Monday, 28 October 2002 at 8AM.

Installation continues until Tuesday, 29 October 2002 at NOON.

Normal installation hours are from 8AM – 6PM.

During normal installation hours, badges and ribbons (for those who registered early) will be available to all exhibitors to gain access to the exhibit hall.

Exhibitors may pick up badges and ribbons at the registration desk.

Badges must be worn at all times during the installation.

Exhibitors may work after hours by making arrangements in advance with one of the Exhibition Chairs or Local Arrangement Chairs.

A storage room will be available to store all the empty boxes and other items. Please have labels available to mark your empty boxes.

## **Dismantling**

Dismantle begins at close of exhibition on Thursday, 31 October at 4PM. No displays can be removed prior to 4PM. All exhibits must be removed by 10PM on the same day since the conference has to release that room for a hotel function early

the next morning. Student volunteers are available throughout the demonstration time to provide any assistance. If you need any help, please contact one of Matt Ward or Kristine Weiland.

**For further information, please contact the demo chair:**

Matthew Ward  
Computer Science Department  
WPI  
100 Institute Rd.  
Worcester, MA 01609  
(508) 831-5671 (voice)  
(508) 831-5776 (fax)  
matt@cs.wpi.edu (e-mail)



## Visualization 2002 Sponsor/Exhibitor Staff Registration Form

Company/University Name: \_\_\_\_\_

Contact name: \_\_\_\_\_

Mailing address: \_\_\_\_\_

City/State/Zip/Country: \_\_\_\_\_

Phone: \_\_\_\_\_ Fax: \_\_\_\_\_

E-mail: \_\_\_\_\_ URL: \_\_\_\_\_

### Sponsor/Exhibitor category:

- Supporter Gold (\$5,000)       Supporter (\$2,500)  
 Non-Profit Supporter (\$500)       Publisher (\$500)  
 Academic Institution Demonstrator (no fee)

### Sponsor/Exhibitor Staff by Name: Print Clearly.

Place an "X" next to name of the individual who is getting the free conference registration. Additional conference attendees should register separately using the web registration (<http://vis.computer.org/vis2002/registration/forms.html>).

	Name	Title
<input type="checkbox"/>	1. _____	_____
<input type="checkbox"/>	2. _____	_____
<input type="checkbox"/>	3. _____	_____
<input type="checkbox"/>	4. _____	_____
<input type="checkbox"/>	5. _____	_____
<input type="checkbox"/>	6. _____	_____
<input type="checkbox"/>	7. _____	_____
<input type="checkbox"/>	8. _____	_____

Please complete this form and FAX on or before 11 October to:

IEEE Computer Society  
1730 Massachusetts Avenue NW  
Washington, DC 20036, USA  
ATTN: Vis Exhibitor Registration  
Phone: +1 202 371 0101, Fax: +1 202 728 0884  
E-mail: [register@computer.org](mailto:register@computer.org)



## Visualization 2002 Exhibitor Hardware Information Form

Company/University Name: \_\_\_\_\_

Contact name: \_\_\_\_\_

**Hardware Information:     Print Clearly.**

Make	Model	Serial No.	Approximate Value	Special Power Requirements (Amp, Voltage, Phase, etc.)

Please provide corkboard(s) for our booth.

Please complete this form and FAX on or before 11 October to:

IEEE Computer Society  
 1730 Massachusetts Avenue NW  
 Washington, DC 20036, USA  
 ATTN: Vis Exhibitor Registration  
 Phone: +1 202 371 0101, **Fax: +1 202 728 0884**  
 E-mail: register@computer.org



## Visualization 2002 Sponsor/Exhibitor Invoice

Company/University Name: \_\_\_\_\_

Contact name: \_\_\_\_\_

### Sponsor/Exhibitor category:

Supporter Gold (\$5,000.00)

Supporter (\$2,500.00)

Non-Profit Supporter (\$500.00)

Publisher (\$500.00)

Please make check payable to "IEEE COMPUTER SOCIETY". All checks must be drawn in US dollars drawn on US banks. Credit card charges will appear on statements as IEEE Computer Society-Registration. Any collection or other fees charged by banks or credit card providers will be passed along to the registrant.

### Method of Payment (Please check one)

Personal Check     Company Check     VISA     MasterCard  
 American Express     Diners Club

<b>Total Amount of Payment</b>	
<b>Credit Card Number</b>	
<b>Cardholders Name</b>	
<b>Expiration Date</b>	
<b>Signature</b>	

### Refund Policy

If a request to cancel a demonstration is received on or before 27 September 2002, 50% of the fees paid will be refunded.

### Please send payment WITH THIS INVOICE to:

IEEE Computer Society  
 1730 Massachusetts Avenue NW  
 Washington, DC 20036, USA  
 ATTN: Vis Exhibitor Registration  
 Phone: 202-371-1013, Fax: 202-728-0884  
 E-mail: kweiand@computer.org